



2014-2018 NTG5.0 C/GLC/VClass W205/X253/C253/W447 Installation Guide



1. Please power off your Original monitor before installation



2. Pry the Center speaker cover out with the included Pry Tool

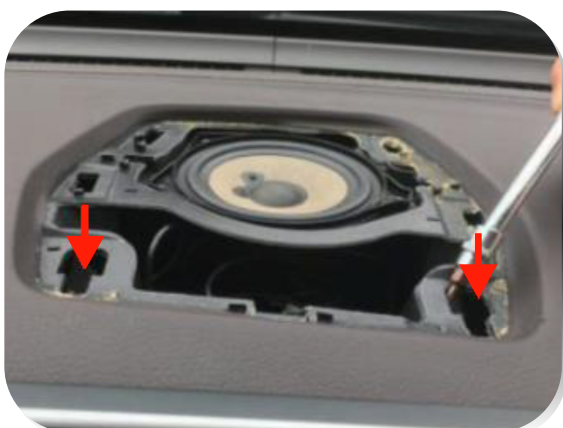

3. Remove the existing screws from original monitor



4. Remove the Original monitor carefully



2014-2018 NTG5.0 C/GLC/VClass W205/X253/C253/W447 Installation Guide

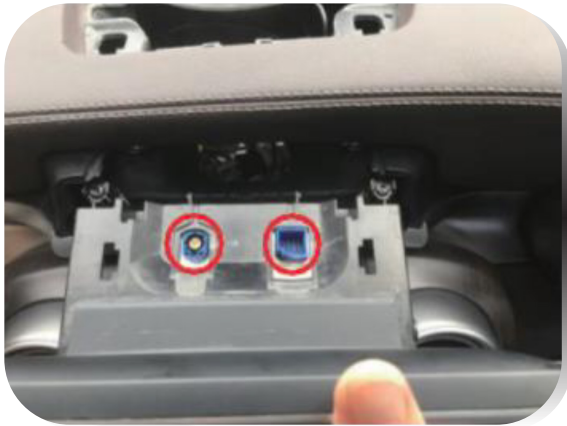

5. Unplug the original monitor from the connector



6. Open the armrest box



7. Pry the decorated cover out with the included pry tool from arm rest box button.



8. Remove the left and right screws



2014-2018 NTG5.0 C/GLC/VClass W205/X253/C253/W447 Installation Guide



9. Pry the central dash board and remove it with the included pry tool.



10. Remove the screws from original host.



11. Remove and unplug the power harness from original host, and connect it to android player's harness. Please refer to wiring harness diagram to determine the wiring locations (Page 10).



12. Plug Audio-USB into USB port which is located in the arm rest box. Please refer to Wiring diagram to determin which USB to use (Page 10).



2014-2018 NTG5.0 C/GLC/VClass W205/X253/C253/W447 Installation Guide



13. Connect original monitor LVDS cable with Android LVDS cable.
Please refer to wiring diagram at Page10 to determine the cable location.



14. Assemble the stand for the Android monitor and place the cables well into the slots provided.



15. Connect the cables to the Android player. Please refer to wiring diagram at Page 10 to determine the cable location.



16. Pry the screw cover out on Android back cover,
and lock the screws.



2014-2018 NTG5.0 C/GLC/VClass W205/X253/C253/W447 Installation Guide



17. Installation Complete

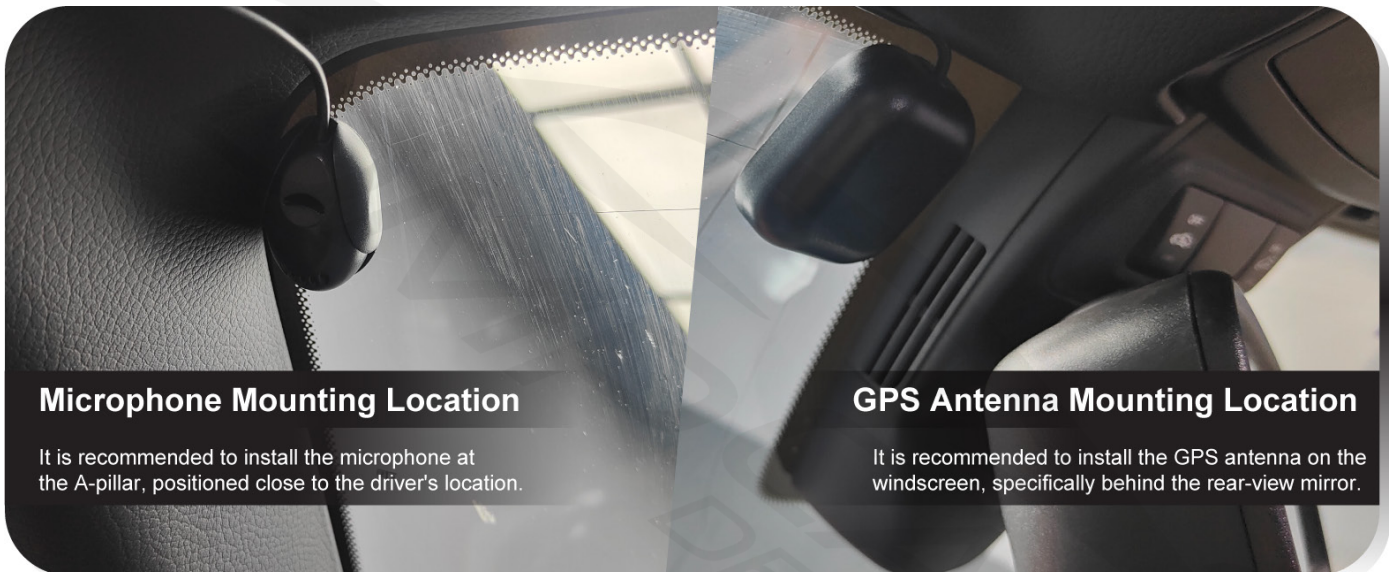

Microphone Mounting Location

It is recommended to install the microphone at the A-pillar, positioned close to the driver's location.

GPS Antenna Mounting Location

It is recommended to install the GPS antenna on the windscreen, specifically behind the rear-view mirror.



After Installation Picture



2014-2018 NTG5.0 C/GLC/VClass W205/X253/C253/W447 Setting Guide



Troubleshoot NTG 5.0 sound issue

Inside Your Glovebox



On your Screen

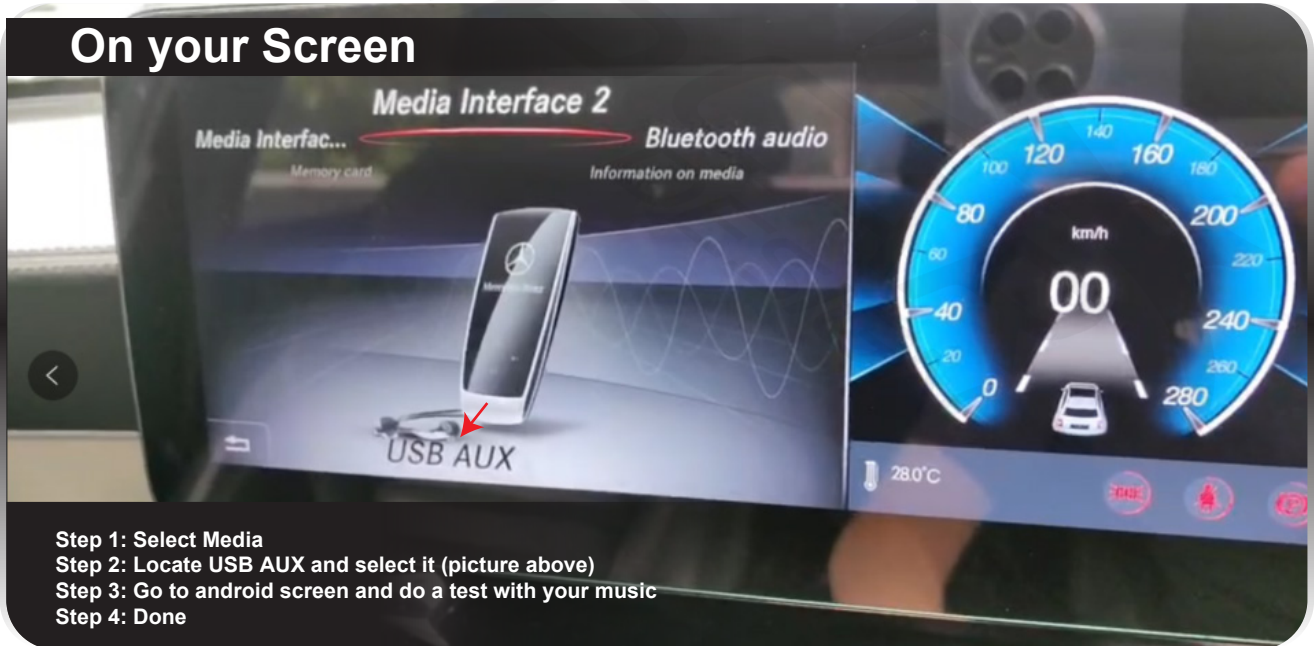

- Step 1: Select Media
- Step 2: Locate USB AUX and select it (picture above)
- Step 3: Go to android screen and do a test with your music
- Step 4: Done



- dmpcardesign
- www.dmpcardesign.com
- www.facebook.com/dmpcardesign

Technical Support:

- +60 11-1095 6055 (Wendy)
- +60 17-607 1426 (Seven)



2014-2018 NTG5.0 C/GLC/VClass W205/X253/C253/W447 Setting Guide



NTG 5.0 Setting instructions

Voice Setting

Audio transfer box (for AUX to USB) Operation Guide

Note: NTG 5.0 system does not have AUX functionality. Android machine requires an external audio transfer box for AUX to USB

1. After plugging the USB-AUX device into the USB interface of the original car, the host recognizes the USB-AUX device in the USB-AUX sources interface, as shown below:



2. Scroll and select USB/AUX sources to enter the page below:

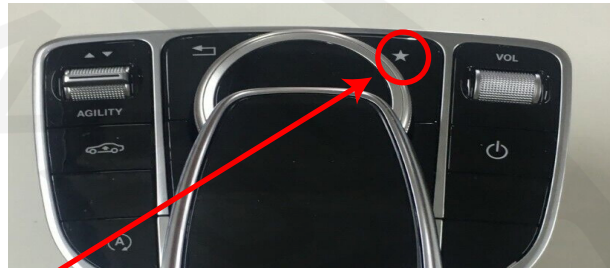

3. Then set the shortcut key, by long press the "★" button on the "COMAND" panel. Afterward, you will enter the main interface as shown below.
4. Starting from the leftmost position, count to the "6th" item on the main interface and place the USB audio device shortcut there.



Starting from the left, place the USB audio device shortcut in the 6th slot.

5. Return to the Android main interface then select: Settings - System - AUX position - set AUX Position to "6"



The original car AUX position is set to "6"

6. If there is no sound after following the above settings, please check the volume of the machine and verify if the optical fiber cable is connected.



2014-2018 NTG5.0 C/GLC/VClass W205/X253/C253/W447 Setting Guide



Sound settings

1. Settings → Volume → Android Volume/OEM Volume
2. Settings → Android → Sound

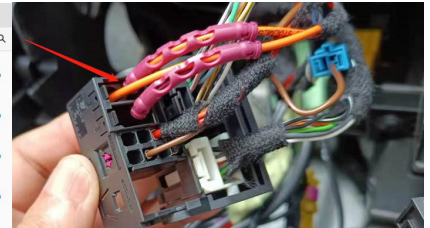
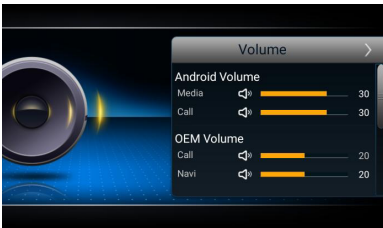

7. If the original car plug has an optical fiber plug but does not have a speaker cable, an additional small speaker is required.

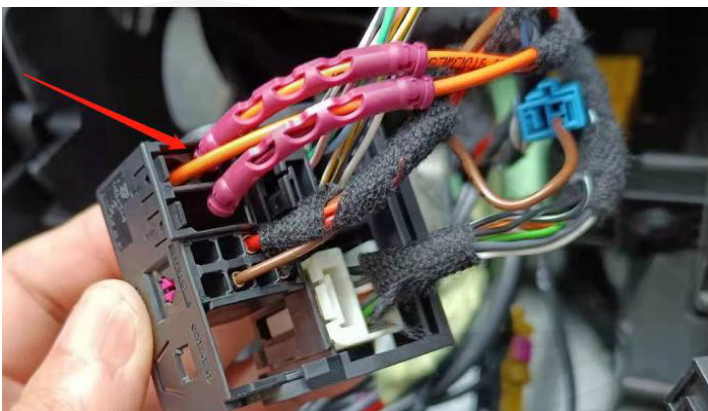

Car Display Setting

1. Car Display : Choose [5]-[8].
Settings → Factory Settings → password: 190627 → Car Display: [5]-[8]

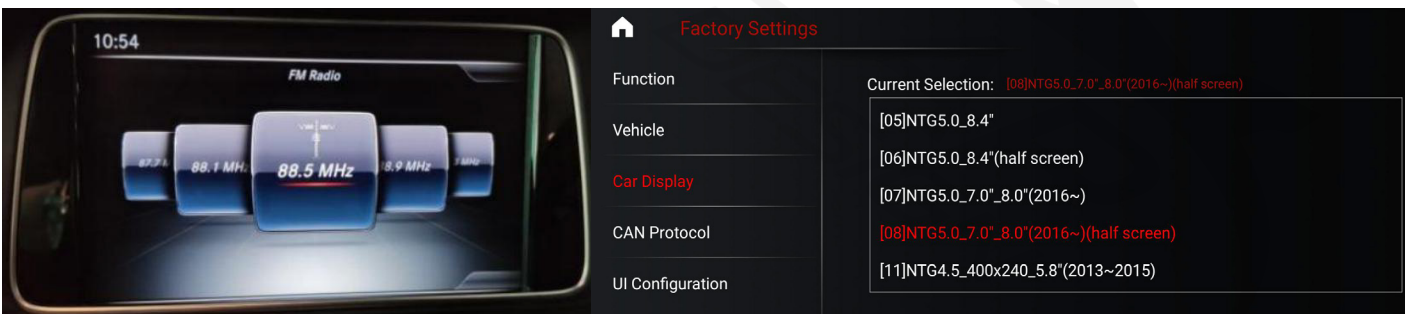

2. CAN Protocol : NTG5.0 does not need to set CAN protocol.

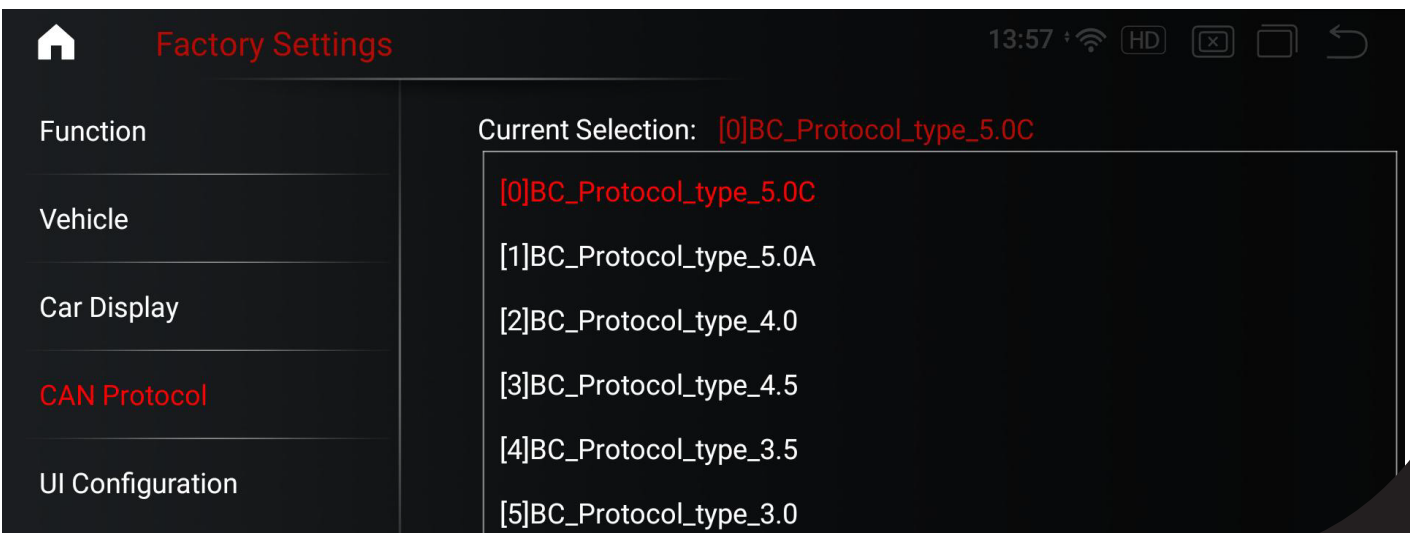



2014-2018 NTG5.0 C/GLC/VClass W205/X253/C253/W447 Setting Guide



Troubleshoot Reverse camera issues on NTG 5.0

If your OEM camera does not function,
try the following steps:

Step: 1

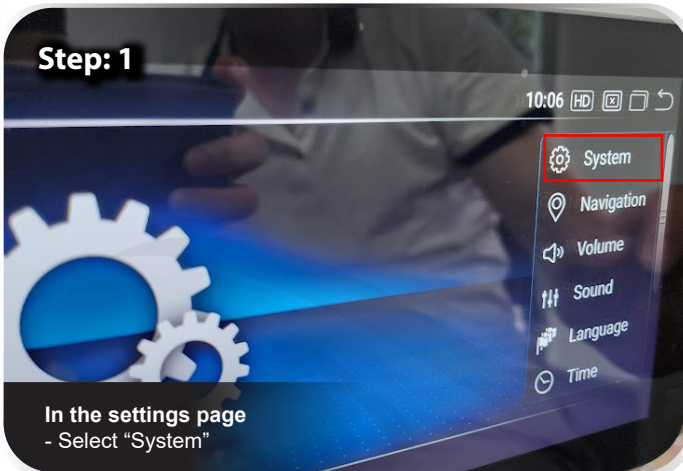

In the settings page
- Select "System"

If your camera does not work on your Android display
but works on the 'Car Info' page, try the following steps

Step: 1

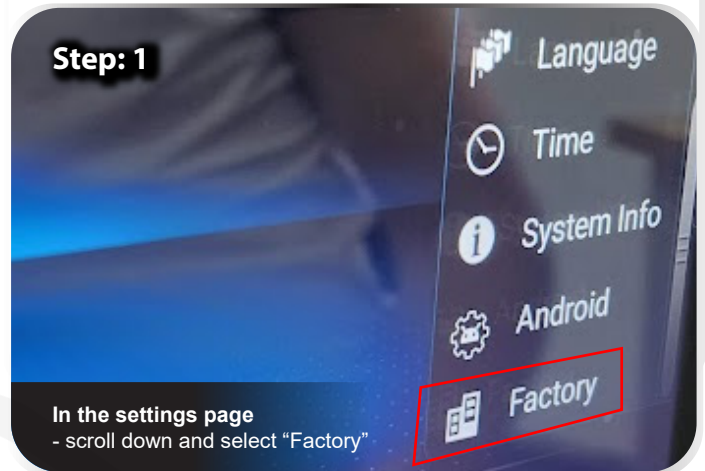

In the settings page
- scroll down and select "Factory"

Step: 2

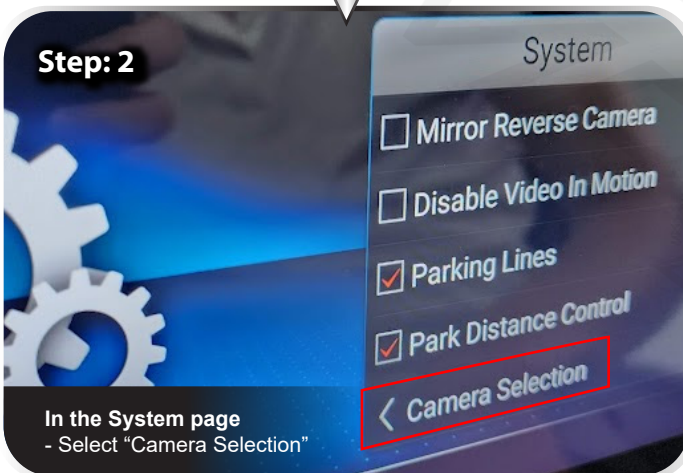

In the System page
- Select "Camera Selection"

Step: 2

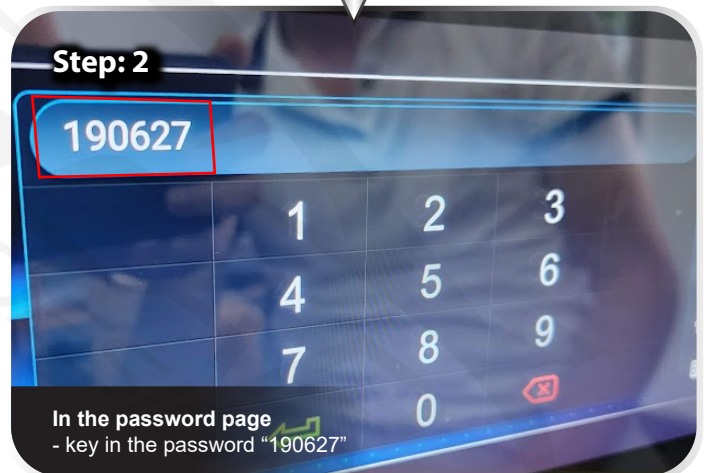

In the password page
- key in the password "190627"

Step: 3



In the Camera Selection page
- Select "OEM Camera"

Step: 3

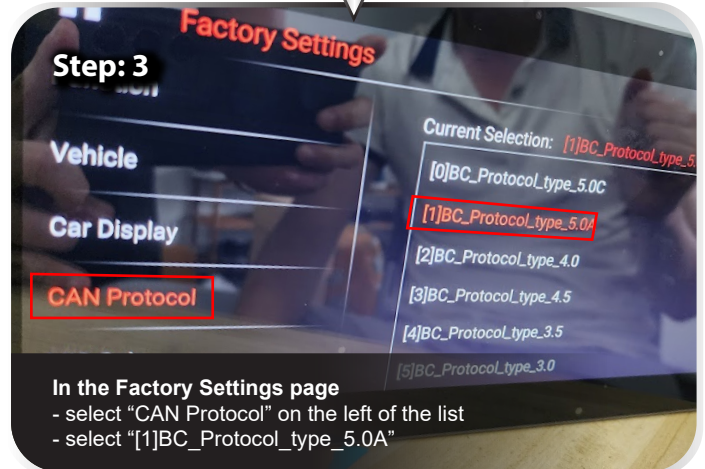

In the Factory Settings page
- select "CAN Protocol" on the left of the list
- select "[1]BC_Protocol_type_5.0A"

Wiring Diagram

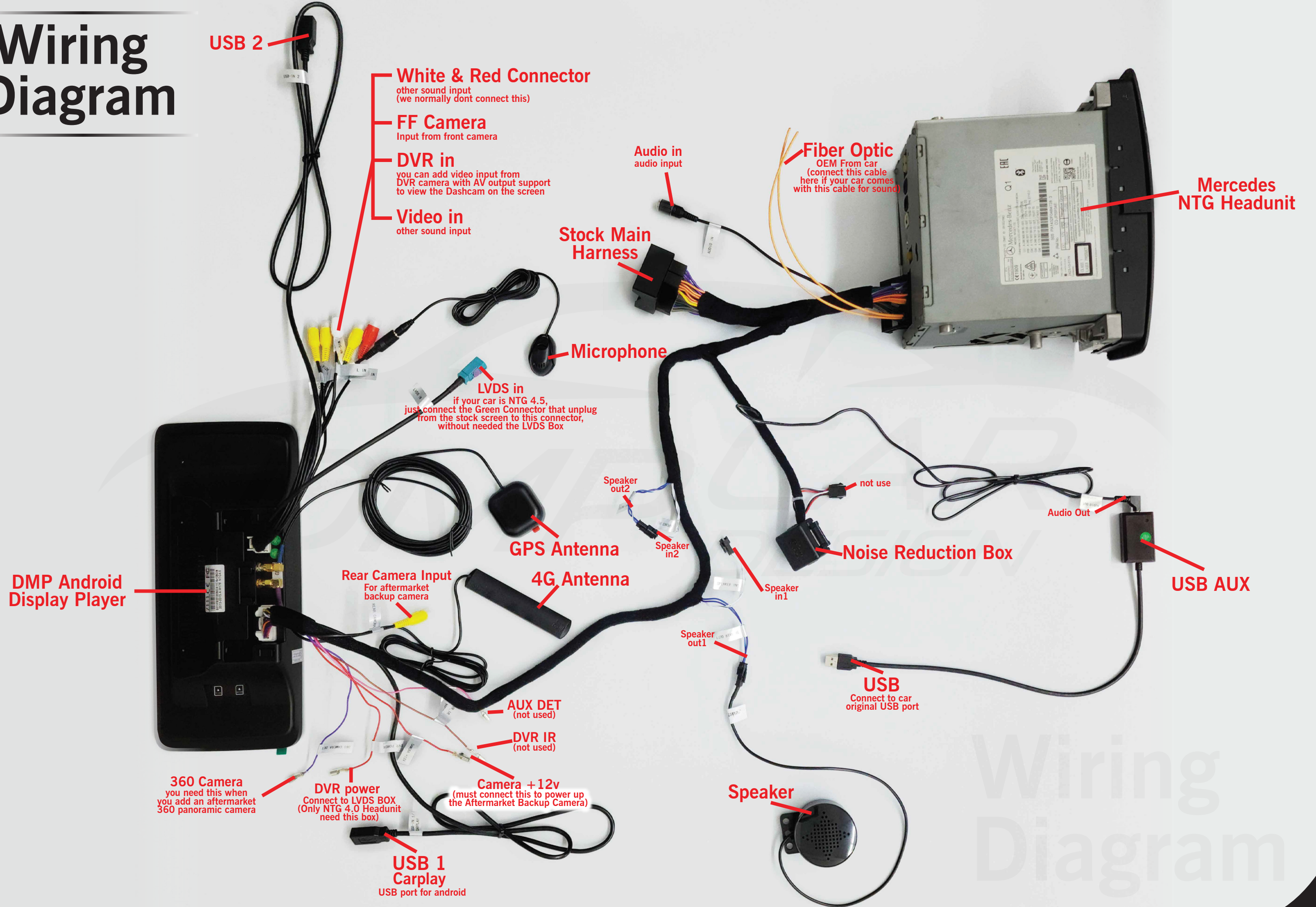

Wiring
Diagram